

## **Works overview**

**Monday 10 June – Friday 21 June:** Closure of the A12 junction 29, Crown Interchange northbound entry slip.

Diversion: traffic will be diverted along the A12 to turn around at junction 28, Severalls Interchange.

**Monday 24 June – Friday 5 July:** Full closure of the A12 northbound between junction 27, Spring Lane Interchange and junction 29, Crown Interchange.

Diversion: traffic will be diverted through Colchester on the A133 and A1232 to re-join the A12 at junction 29, Crown Interchange.

**Tuesday 9 July - Wednesday 10 July:** Closure of the A120 Crown Interchange westbound exit slip road.

Diversion: traffic will be diverted along the A12 to turn around at junction 28, Severalls Interchange, before exiting at junction 29, Crown Interchange.

**Thursday 11 July – Monday 15 July:** Closure of the A120 westbound carriageway between Crown Interchange and its merge with the A12 southbound carriageway.

Diversion: traffic will be diverted through Colchester on the A1232 and A133 to join the A12 at junction 27, Spring Lane Interchange.

**Monday 8 July:** Closure of the A12 northbound exit and entry slip road at Park Lane, Langham.

Diversion: traffic will be diverted to turn around at the next junction, before following a local diversion via Birchwood Road and Wick Road.

**Wednesday 10 July:** Closure of the A12 southbound exit and entry at Birchwood Road, Langham.

Diversion: traffic will be diverted to turn around at junction 29, Crown Interchange, before following a local diversion via Park Lane and Wick Road.

**Tuesday 16 July:** Closure of the A120 Crown Interchange eastbound entry slip road. Access to Old Ipswich Road (south) will be restricted.

Diversion: traffic wishing to join the A120 will be diverted along the A12 to turn around at junction 28, Severalls Interchange, before joining the A120 at Crown Interchange.

Traffic wishing to join Old Ipswich Road (south) will be diverted along the A12 to turn around at Langham, then exit onto Old Ipswich Road (north).

**Monday 22 July:** Access from Old Ipswich Road (north) to the Crown Interchange will be restricted.

Diversion: traffic will be diverted along the A12 via Turnpike Close to turn around at Langham then exit the A12 southbound carriageway at junction 29.

### What to expect

- Prolonged periods of medium to high level noise associated with the use of geotechnical survey equipment.
- Short, intermittent periods of medium to high level noise associated with the use of carriageway survey equipment.

### Old Ipswich Road diversion

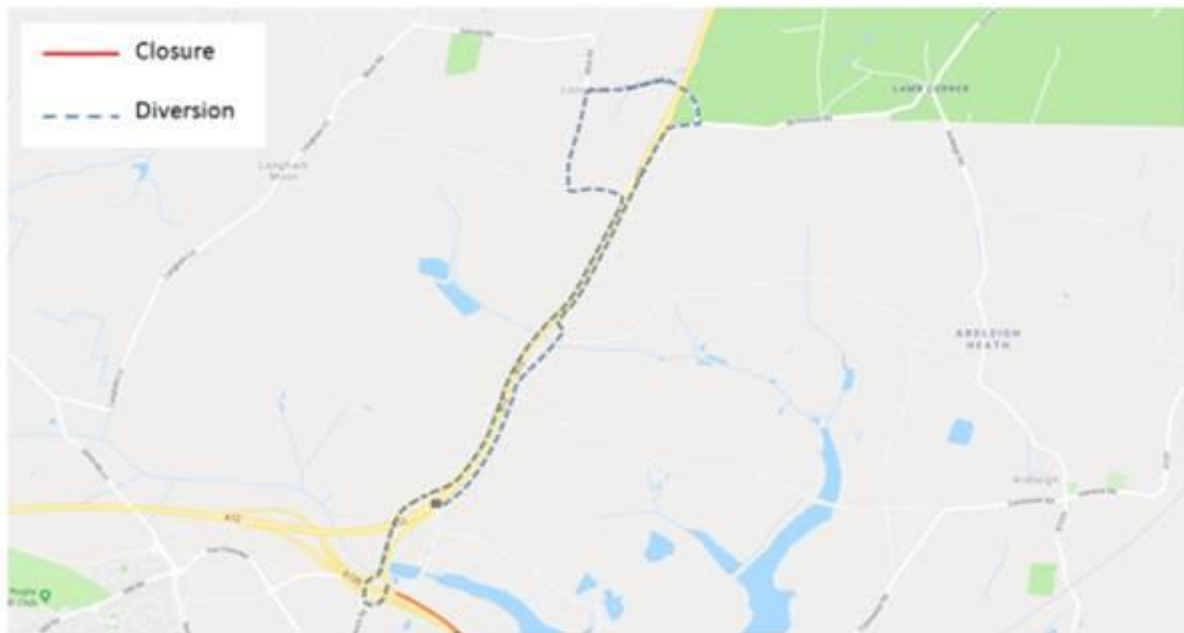

### A12 diversion between junctions 27 and 29

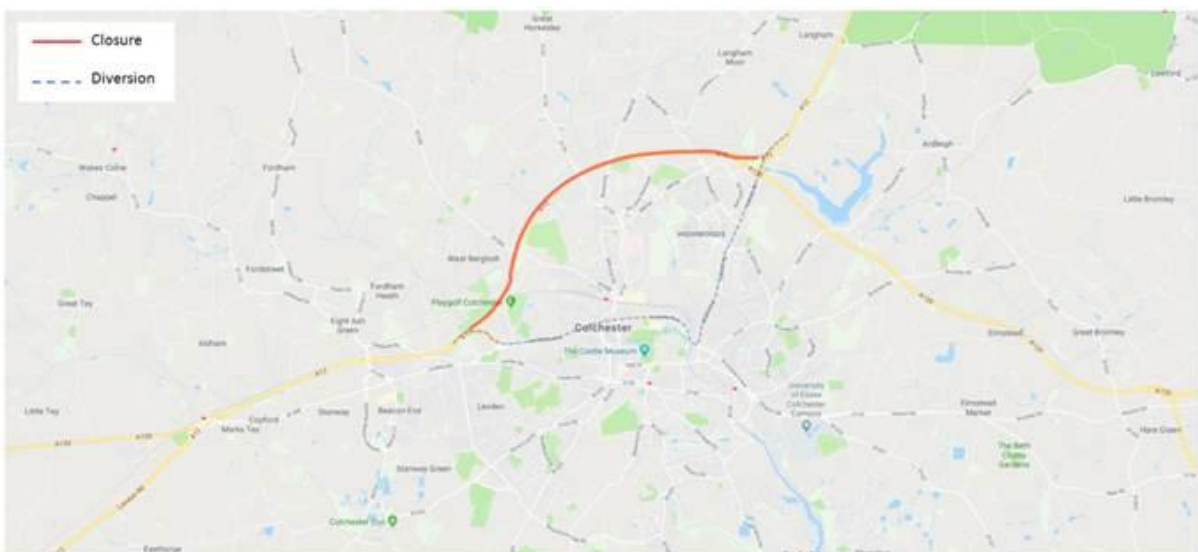

### Find out more

We have carefully planned these works to take place during weekday off peak hours, when traffic flows are at their lightest. We apologise for the local inconvenience these works may

cause and thank you for your patience whilst we carry out strategic maintenance to the road network. We would be grateful if you would share information locally about the works.

To stay informed about all the latest major roadworks happening near you, visit [www.gov.uk/government/organisations/highways-england](http://www.gov.uk/government/organisations/highways-england) to register for the latest alerts.

If you have any enquiries about this work, please contact the Highways England Customer Contact Centre referencing this letter, on 0300 123 5000, or by e-mail to [info@highwaysengland.co.uk](mailto:info@highwaysengland.co.uk)